

40-418

Tube-Type

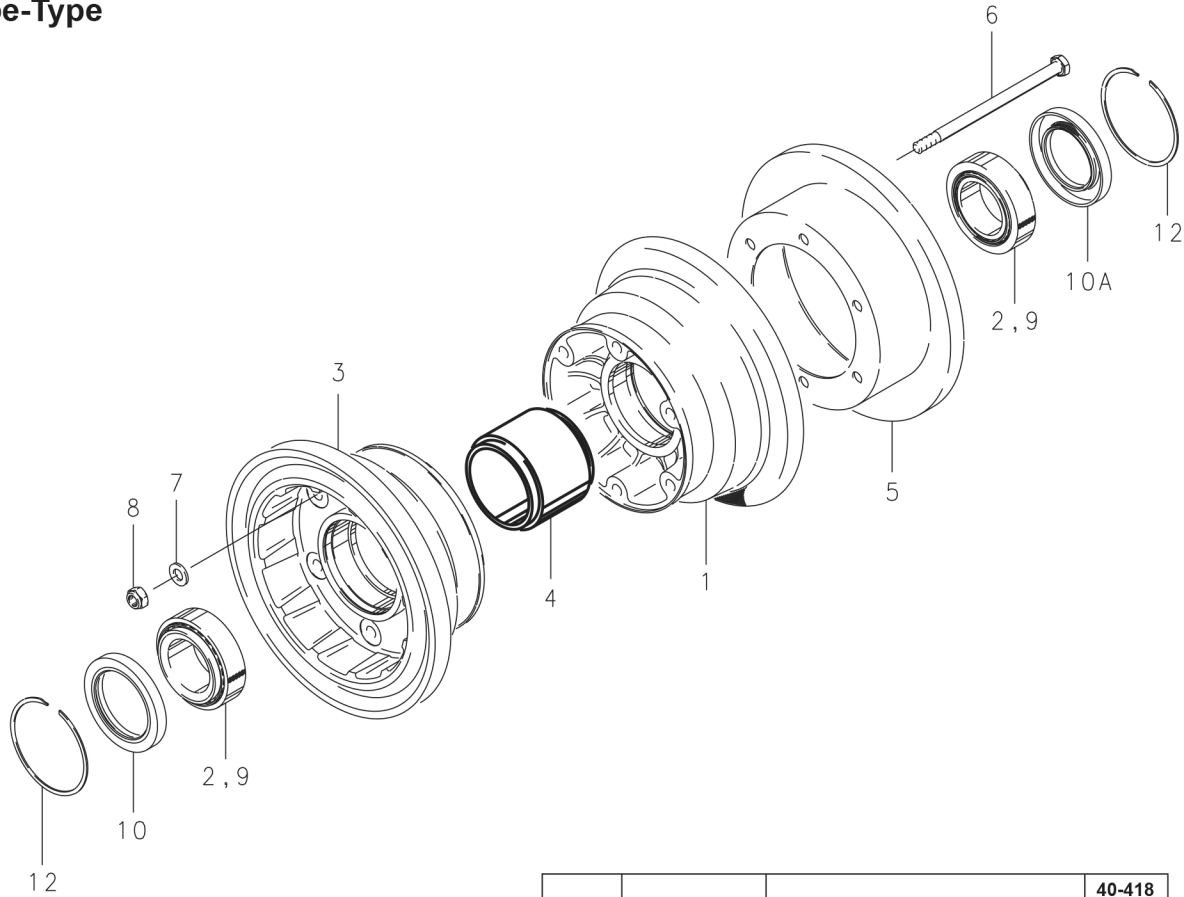

NOTES:

- (1) High corrosion resistant, amphibious equipment.
- (2) Alternate chrome plated disc.

FIG.	PART NO.	DESCRIPTION	40-418 (1)
1	161-19900	Inner Wheel Half Assembly	1
2	214-01100	Cup-Bearing (chrome plated)	1
3	162-19900	Outer Wheel Half Assembly	1
2	214-01100	Cup-Bearing (chrome plated)	1
4	067-14700	Grease Dam Spacer	1
5	164-24500	Brake Disc	1
	164-24501 (2)	Brake Disc (Chrome)	1
6	103-20400	Bolt (AN5-35A)	6
7	095-10500	Washer (AN960-516)	6
8	094-12700	Nut (MS21042-5)	6
9	214-01200	Cone-Bearing (chrome plated)	2
10	154-08300	Molded Grease Seal	1
10A	154-08200	Molded Grease Seal	1
12	155-14300	Snap Ring	2